

039202343G

PAD2 Electric cooling pump



The PAD2 coolant pump is an electronically commutated centrifugal pump. It can be used in a variety of applications, such as supporting the heating circuit, for residual heat utilization and component cooling, as well as for turbochargers and charge-air cooler. As part of the thermal management system, it can contribute to CO₂ reduction.

The low noise level and long service life also enable its use in hybrid and electric vehicles, where can be used, for example, to cool the power electronics modules.

- **Degree of protection:** IPX7
- **Operating mode:** S1
- **Nominal Voltage:** 12 V

[Contact us!](#)



Product Specification

Technical data and performance curve

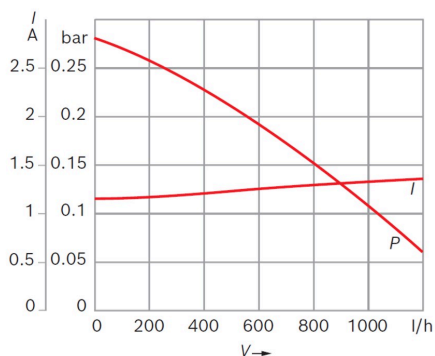

Flow rate (l/h): 500

Nominal pressure (bar): 0,2

Nominal Voltage (V): 12

Weight (kg): 0,325

Control: PWM

Medium: Water/Glycol (50/50)

Product images and pictures are for demonstration purposes only, the actual product may differ from the picture shown. The quotation drawing is binding.

Robert Bosch GmbH, Auf der Breit 4, 76227 Karlsruhe, Germany www.bosch-ibusiness.com



Dimensions

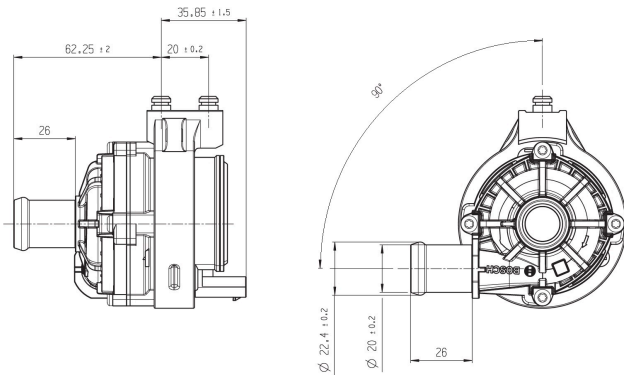

Please contact us if you need a 3d model

[Contact](#)

Connector

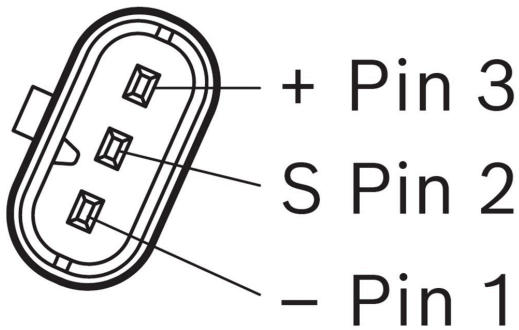

Housing:

- TE Connectivity MCON 1.2 1488991-6 (with CPA),...-2 w/o CPA
- Molex MXP120 34900-3102

Terminal:

- Bosch 1 928 498 811
- Tyco / Molex MCON 1.2 1670146-3 – Ag plated (20awg)
- KOSTAL MLK 1.2 [32124734130]

Seal:

- Bosch 1 928 300 936
- TE Connectivity 967067-1 (20 awg)
- KOSTAL 10800507250

Application examples

- Cooling modules for trailers, containers or construction machines
- Cooling of batteries
- After-run cooling of components in the powertrain



Downloads

You may also be interested in:

To Product family: [Catalogue](#)

