

0130115017

# GBM-S DC motor

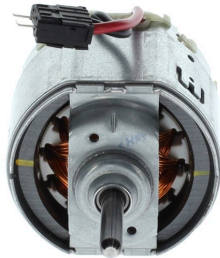

- **Degree of protection:** IP 10
- **Operating mode:** S1
- **Nominal voltage:** 12 V

[Contact us!](#)

## Product Specification

### Technical data and performance curve

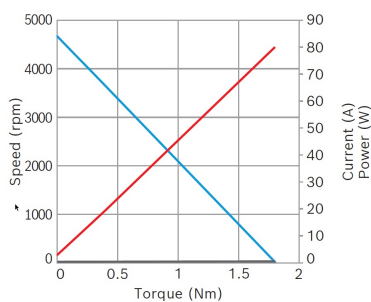
**Nominal power (W):** 122,5**Nominal current (A):** 115**Nominal speed (rpm):** 3900**Nominal torque (Nm):** 0,3**Stall torque (Nm):** 1,8**Hall Sensor:** No

Product images and pictures are for demonstration purposes only, the actual product may differ from the picture shown. The quotation drawing is binding.

**Robert Bosch GmbH**, Auf der Breit 4, 76227 Karlsruhe, Germany [www.bosch-ibusiness.com](http://www.bosch-ibusiness.com)



## Dimensions

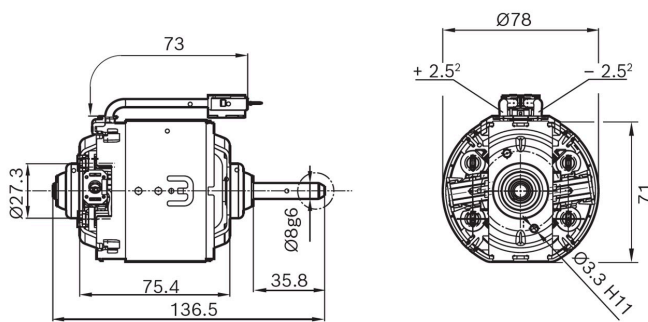

Please contact us if you need a 3d model

[Contact](#)

## Circuit diagram

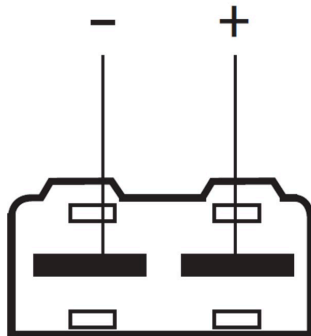

## Connector

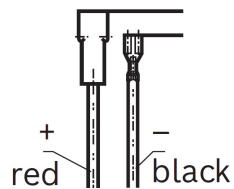

---

## Drive interface

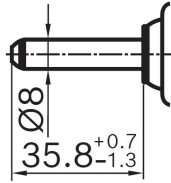

---

## Downloads

You may also be interested in:

To Product family: [Catalogue](#)

